

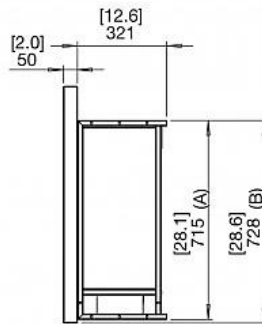

UTECOMFORT

Curved series firebox 1100CV
Technical details

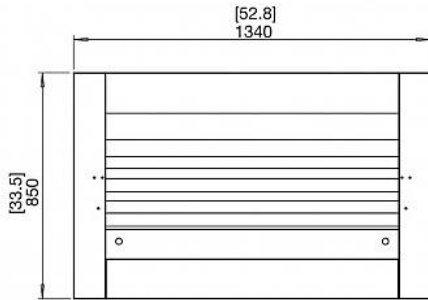

(A) FRAME HEIGHT
(B) FIREBOX HEIGHT

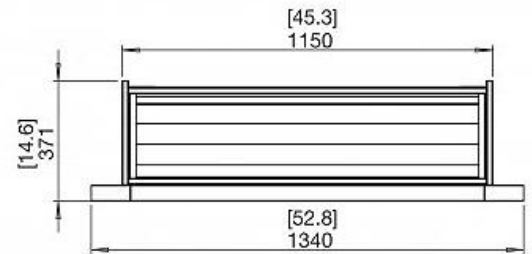

Weight: 61.50 kg
 Model dimensions (mm): W 1340, D 371, H 850
 Viewing area (mm): W 1340, D 321, H 850
 Application: Indoor / outdoor
 Materials: Mild steel, toughened glass
 Colour: Black

Read the manual carefully before operating the burner. Physical model dimensions should be verified against cut out dimensions BEFORE installation begins to confirm tolerances align.

The Firebox 1100CV is a manufacturer approved surround for the BS EN16647 Compliant XL900 burner.

VOLUME CAPACITY	HEATS ON AVERAGE	MINIMUM ROOM	THERMAL OUTPUT	FUEL EFFICIENCY
9 L	60 m ²	110 m ³	15000 BUT/hr 4.4 kW/h	8-13 h 9 Litres

*These values are indicative only and may vary depending on the model purchased, installation environment, and the composition of the e-NRG bioethanol sourced in each country.